



SEA®
Sistemi Elettronici
di Apertura Porte e Cancelli
International registered trademark n. 804888

CE

English

LEPUS BOX 6000

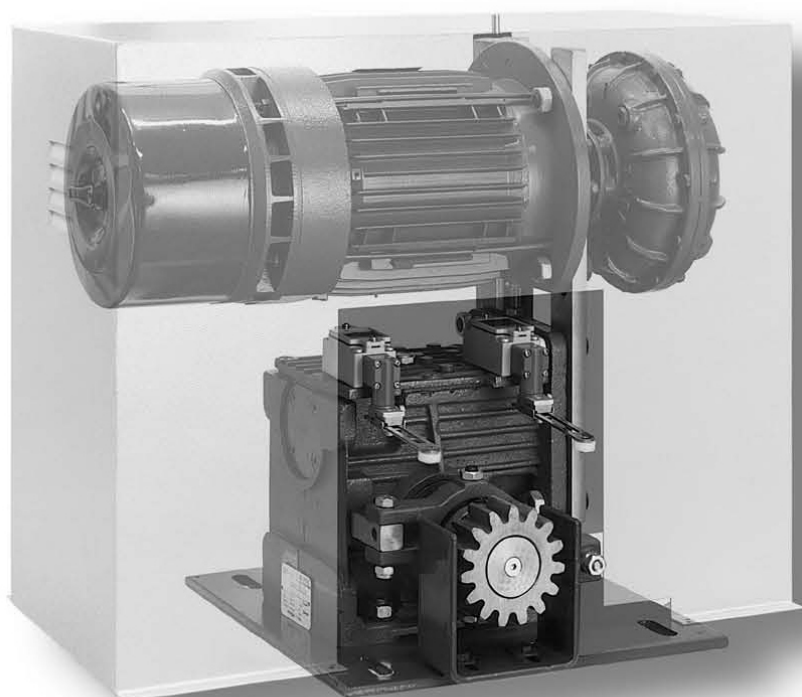

IRREVERSIBLE OPERATOR FOR SLIDING GATE

Operator

LEPUS BOX 6000

Power Supply

400V 3~ 50Hz

Max gate weight

6000 kg / 13200 lbs

Max Thrust

900 kg / 1980 lbs

code

11115100



IMPORTANT SAFETY INSTRUCTIONS FOR THE INSTALLATION

- ATTENTION -

FOR THE SAFETY OF THE PEOPLE IT IS IMPORTANT
TO FOLLOW ALL THE INSTRUCTIONS.

FOLLOW ALL INSTALLATION INSTRUCTIONS

- 1° - This handbook is exclusively addressed to the specialized personnel who knows the constructive criteria and the protection devices against the accidents for motorized gates, doors and main doors (follow the standards and the laws in force).
- 2° - The installer will have to issue to the final user a handbook in accordance with the EN 12635.
- 3° - Before proceeding with the installation, the installer must forecast the risks analysis of the final automatized closing and the safety of the identified dangerous points (following the standards EN 12453/EN 12445).
- 4° - The wiring harness of the different electric components external to the operator (for example photoelectric cells, flashlights etc.) must be carried out according to the EN 60204-1 and the modifications to it done in the point 5.2.2 of the EN 12453.
- 5° - The possible assembly of a keyboard for the manual control of the movement must be done by positioning the keyboard so that the person operating it does not find himself in a dangerous position; moreover, the risk of accidental activation of the buttons must be reduced.
- 6° - Keep the automatism controls (push-button panel, remote control etc.) out of the children way. The controls must be placed at a minimum height of 1,5 m from the ground and outside the range of the mobile parts.
- 7° - Before carrying out any installation, regulation or maintenance operation of the system, take off the voltage by operating on the special magnetothermic switch connected upstream it.

THE SEA COMPANY DOES NOT ACCEPT ANY RESPONSIBILITY for possible damages caused by the non observance during the installation of the safety standards and of the laws in force at present.

KEEP THESE INSTRUCTIONS WITH CARE

- 1° - Install a thermal magnetic switch (omnipolar, with a minimum contact opening of 3 mm) before the control board, in case this is not provided with it. The switch shall be guaranteed by a mark of compliance with international standards. Such a device must be protected against accidental closing (e.g. Installing it inside the control panel key locked container).
- 2° - As far as the cable section and the cable kind are concerned, SEA suggests to use a cable, with a minimum section of 1,5mm², and to follow, in any case, the IEC 364 standard and Installation regulations in force in your Country.
- 3° - Positioning of an eventual pair of photocells: The beam of the photocells must be at an height not above the 70 cm from the ground, and, should not be more than 20 cm away from the axis of operation of the gate (Sliding track for sliding gate or door, and the hinges for the swing gate). In accordance with the point 7.2.1 of EN 12445 their correct functioning must be checked once the whole installation has been completed.
- 4° - In order to comply with the limits defined by the EN 12453 norm, if the peak force is higher than the limit of 400N set by the norm, it is necessary to use an active obstacle detection system on the whole height of the gate (up to a maximum of 2,5 m) - The photocells in this case must be applied externally between the columns and internally for all the race of the mobile part every 60÷70 cm for all the height of the column of the gate up to a maximum of 2,5 m (EN 12445 point 7.3.2.1). example: column height 2,2 m => 6 copies of photocells - 3 internal and 3 external

N.B.: The system must be grounded

Data described by this manual are only Indicative and SEA reserves to modify them at any time. Install the system complying with current standards and regulations.



SYSTEM LAY-OUT

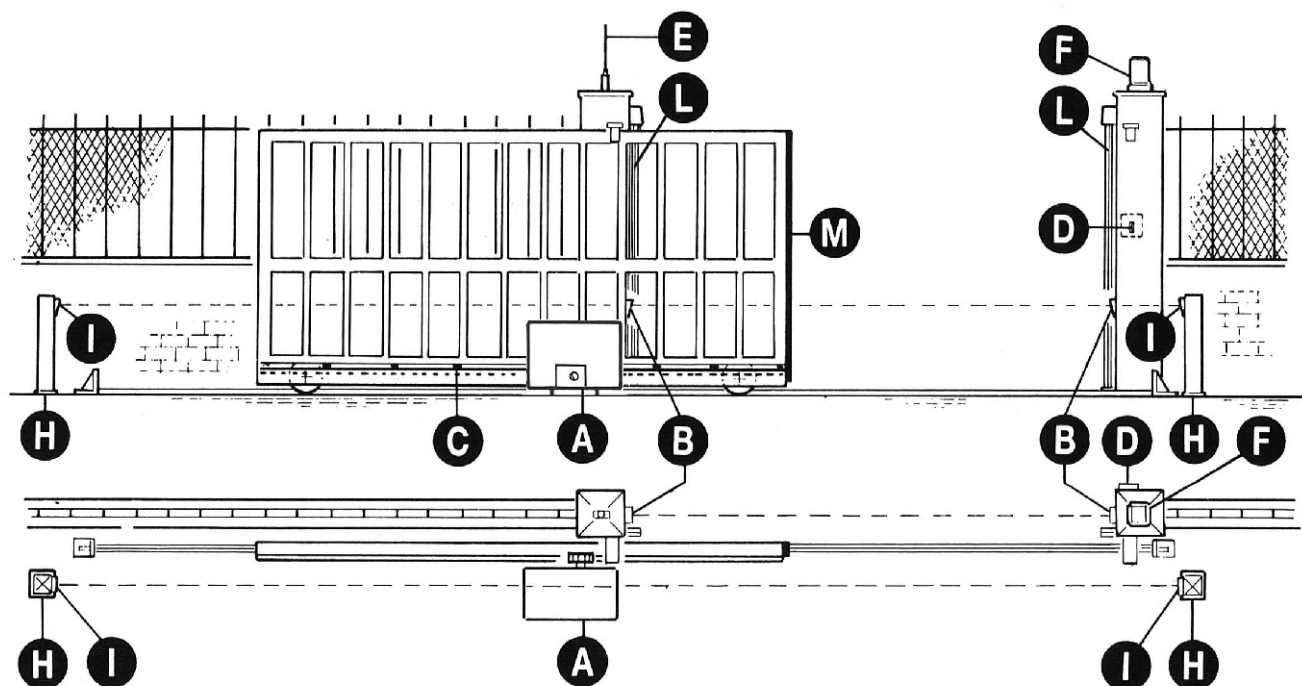

- A - LEPUS BOX 6000 operator
- B - Photoelectric cells (external)
- C - Rack M6
- D - Key selector
- E - Tuned aerial
- F - Flashing lamp
- H - Galvanized column for P.E. cells
- I - Photo electric cells (internal)
- L - Safety strip fixed to column
- M - Mecanichal or electrical safety strip

1

TECHNICAL FEATURES

Irreversible operating devices for sliding gates with a maximum weight of 6000 kg / 13.200 lbs.

LEPUS BOX 6000 is equipped with an easily adjusted hydraulic clutch which will not be affected by the various temperature changes. This softens the starts, stops and reversals of heavy gates.

Its self-braking motor is able to limit gate inertia during the stopping phase.

TECHNICAL DATA	LEPUS BOX 6000
Max. leaf weight	kg/lbs 6000/13200
Operating speed	m/s. 0,160
Thrust force to constant turns	N 9000
Rack	6
EEC Power supply	400V 3~ 50Hz
Motor capacity	W 3000
Power absorbed	A 6,9
Normative cycles	n° 300 - 95s/2s
Power supply	380V 3~ 60Hz
Motor capacity	W 3000
Power absorbed	A 6,9
Normative cycles	n° 300 - 95s/2s
Power supply	220V 3~ 60Hz
Motor capacity	W 3000
Power absorbed	A 11,9
Normative cycles	n° 300 - 95s/2s
Lubrification	SEA 0X68
Weight of electroreducer	kg 123
Noise	db <70
Working temperature	°C -10 ÷ +55
Protection	IP 557

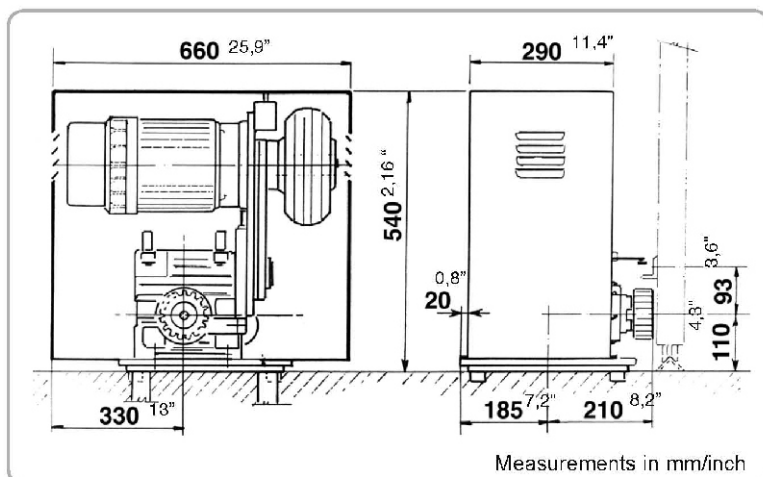



INSTALLATION LEPUS BOX 6000

CHECKING BEFORE THE INSTALLATION

!! THE GATE SHALL MOVE FRICTIONLESS !!

N.B.: Gate features must be uniformed with the standards and laws in force. The door/gate can be automated only if it is in a good condition and its conditions comply with the EN 12604 norm.

- The door/gate leaf does not have to have a pedestrian opening. In the opposite case it is necessary to take the appropriate steps, in accordance with EN 12453 norm (for instance; by preventing the operation of the motor when the pedestrian opening is opened, by installing a safety microswitch connected with the control panel).
- Besides the electrical or mechanical limit switches available on the operators, there must be, on both ends of the installation, a fixed mechanical stopper which stop the gate in the unlikely event of ill functioning of limit switches on the operators. For this reason the fixed mechanical stopper must be of an adequate size to withstand the static and kinetic forces generated by the gate (12) (Fig.2). The guide must be provided with two mechanical stops at its ends (12) (Fig. 2).
- Gate columns shall have anti-derailment guides on their top (Fig. 3), to avoid the unintentional gate release. The guide must be provided with two mechanical stops at its ends (L) (Fig. 2).

N.B.: Eliminate those mechanical stops of the kind described by pic. 3. No mechanical stop shall be on top of the gate, since mechanical stops are not safe enough.

Parts to install meeting the EN 12453 standard

COMMAND TYPE	USE OF THE SHUTTER		
	Skilled persons (out of public area*)	Skilled persons (public area)	Unrestricted use
with manned operation	A	B	
with visible impulses (e.g. sensor)	C	C	C and D
with not visible impulses (e.g. remote control device)	C	C and D	C and D
automatic	C and D	C and D	C and D

* a typical example are those shutters which do not have access to any public way.

A: Command button with manned operation (that is, operating as long as activated)

B: Key selector with manned operation

C: Safety edges

D: Photocells (To apply every 60÷70 cm for all the height of the column of the gate up to a maximum of 2,5 m - EN 12445 point 7.3.2.1).

EMERGENCY RELEASE

To be undertaken after disconnecting power supply.

The operator is irreversible and keeps the door closed even without a lockset.

To open the gate manually, in open the motor cover and turn the knob «A» anti-clockwise.

To restore electric working you have to turn the lever clockwise (Fig. 4). In order to carry out the manual operation of the gate leaf the followings must be checked:

- That the gate is endowed with appropriate handles;
- That these appropriate handles are placed so to avoid safety risks for the operator;
- That the physical effort necessary to move the gate leaf should not be higher than 225 N, for doors/gates for private dwellings, and, 390N for doors/gates for commercial and industrial sites (values indicated in 5.3.5 of the EN 12453 norm).

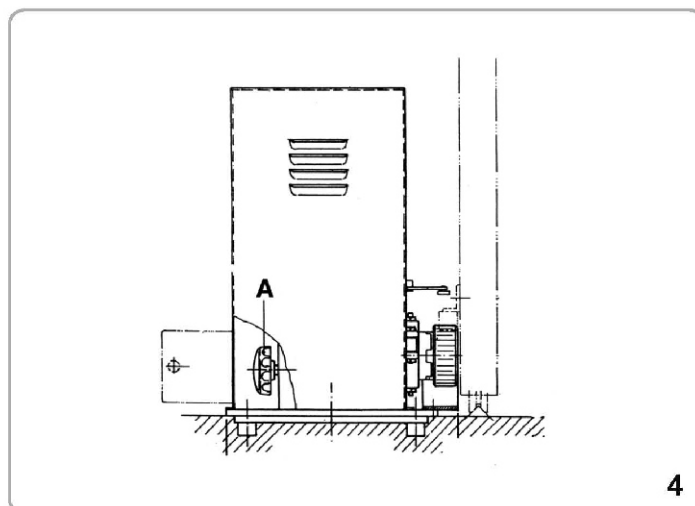
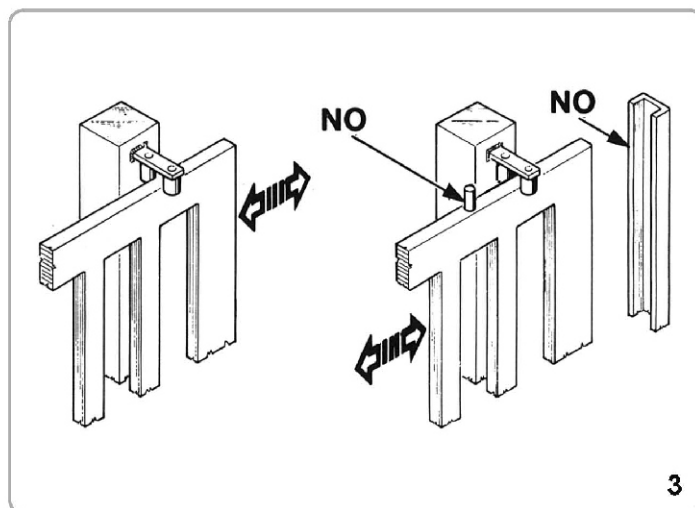
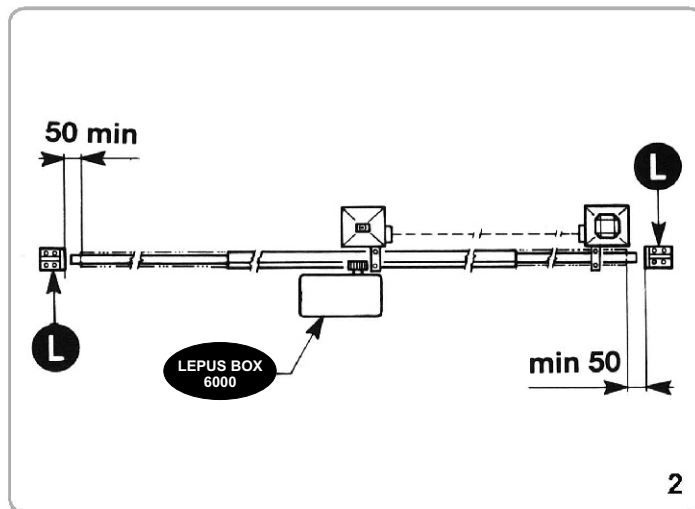



MOTOR AND RACK INSTALLATION

LEPUS BOX 6000 has a plate to be cemented to the ground and is locked in place by the four supplied 14x45 hex bolts using a N° 22 setscrew wrench.

The rack must be fixed at a certain height with respect to the motor base.

This height can be varied thanks to the slots on the rack.

The rack must not be welded, but simply fixed to the gate with threaded screws.

The height needs to be adjusted so that the gate does not rest on the reduction unit traction gear (Fig. 5,6).

Holes with a diameter of 7 mm should be made to fix the rack into the gate, and they should be threaded using a M8 type screw tap.

The pinion must have a clearance of 1 to 2 mm with respect to the rack.

LIMIT SWITCH ADJUSTMENT

LEPUS BOX 6000 has two independent watertight limit switches mounted on the reduction gear. These are able to stop the gate from moving.

HYDRAULIC CLUTCH ADJUSTMENT

Unscrew plug A, remove three-quarters of the oil in the hydraulic clutch, then re-tighten the plug. Now gradually add small amounts of the removed oil through the hole of plug B until the gate starts to move at a progressive speed (it must reach normal running speed within 2 seconds).

CLUTCH MAINTENANCE

Change the oil for the first time after 2 months service and once a year from then on.

ADJUSTING THE V-BELTS

LEPUS BOX 6000 has two V-belts that transmit power from the motor-clutch unit to the reduction gear. These two belts are adjustable and their tension can be varied by shifting the motor-clutch unit in height.

To do this, use a N° 22 wrench to release the four bolts that fix the motor to the slideways. Now use a N° 17 wrench to turn the screw between the reduction gear and motor clockwise to slacken the belts, or anticlockwise to tighten them.

NOTE: It is absolutely essential to comply with this procedure to prevent the reduction gear from being excessively stressed by kick-back from the gate when starting, stopping and reversing (the part should be replaced every 2 years).

NOTE: The V-belts will have already been adjusted when LEPUS BOX 6000 is supplied.

MAINTENANCE

To be undertaken only by specialized staff after disconnecting power supply.

Clean the sliding guide of stones and dirt periodically only when the gate does not move.

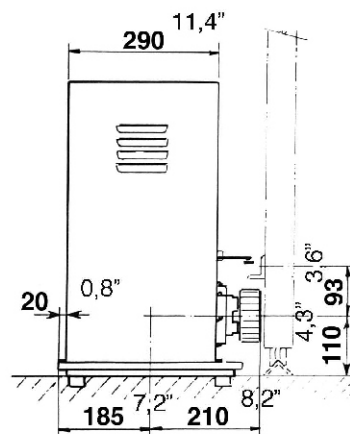

Measurements in mm/inch

5

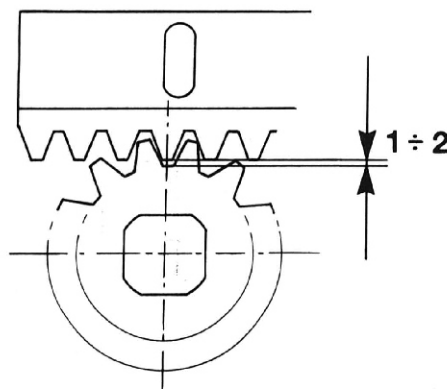

6

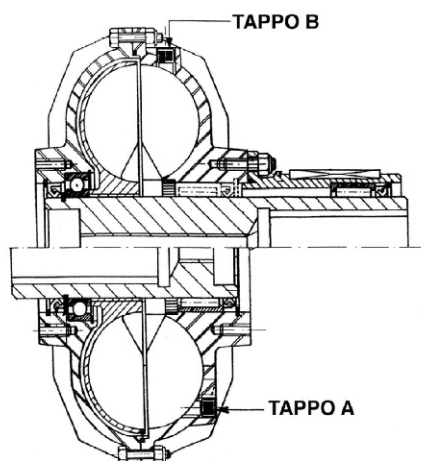

7



LEPUS BOX 6000

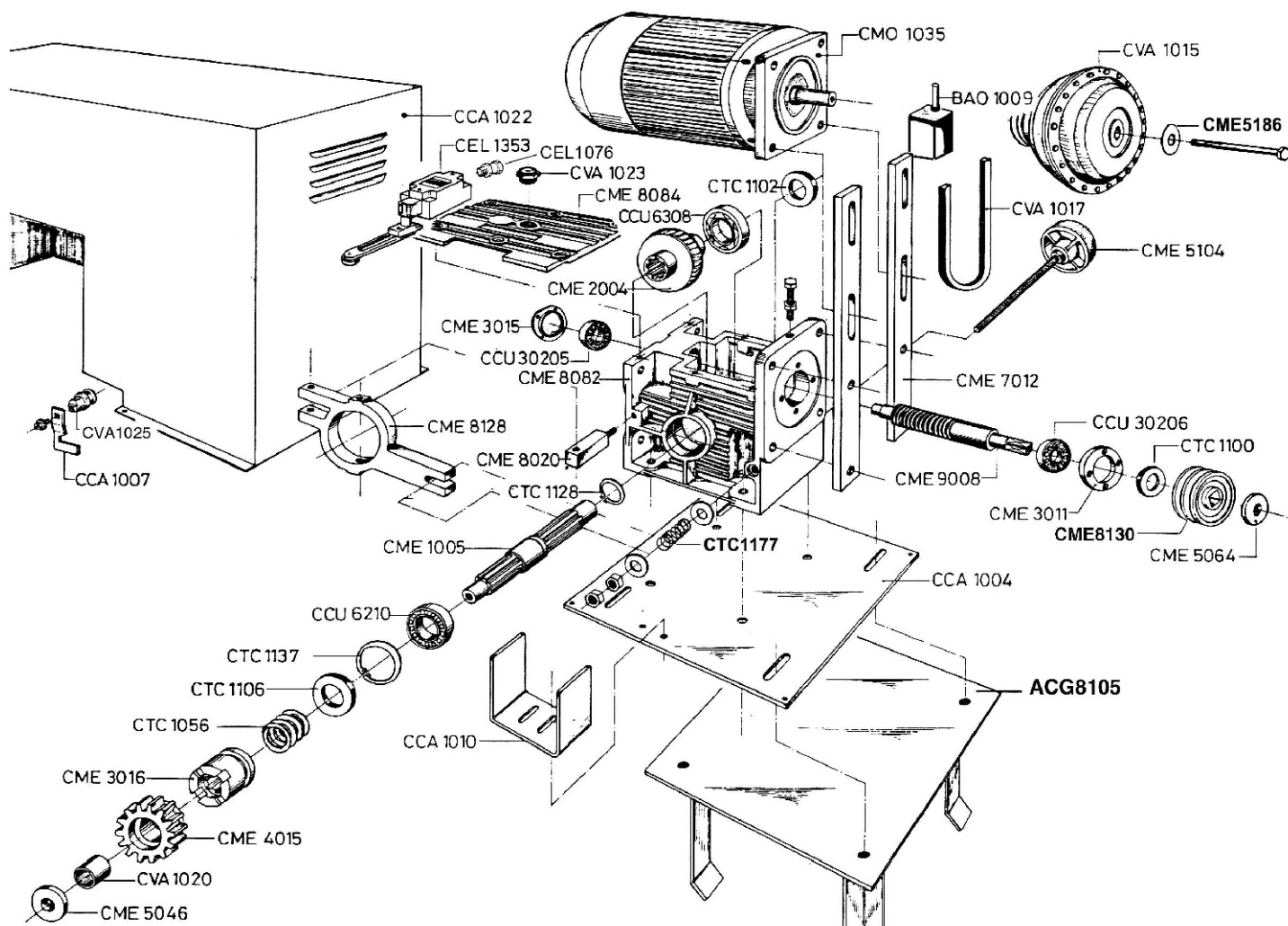

Codice	Descrizione
ACG8105	Piastra da interrare LEPUS BOX 6000
BA01009	Scat. Sicurezza LEPUS
CCA1004	Piastra di base LEPUS BOX 6000
CCA1007	Gancio per serratura
CCA1010	Protezione ingranaggio LEPUS BOX 6000
CCA1022	Carter LEPUS BOX 6000
CCU30205	Cuscinetto 30205 25 52 16,25
CCU30206	Cuscinetto 30206 30 62 17,25
CCU6210	Cuscinetto 6210 50 90 20
CCU6308	Cuscinetto 6308 40x90x23
CEL1076	Pressacavo PG13.5
CEL1353	Finecorsa 3SE3120-1U
CME1005	Albero di traino LEPUS BOX 6000
CME2004	Corona bronzo con mozzo ghisa Z=42
CME3011	Flangetta posteriore
CME3015	Flangia coperchio
CME3016	Giunto innesto
CME4015	Ingranaggio di traino
CME5046	Piattello di fermo
CME5050	Rondella
CME5064	Rondella
CME5104	Manopola di sblocco

Codice	Descrizione
CME7012	Guida scorrimento motore
CME7013	Piastrina porta sicurezza
CME8020	Bloccetto biella di sblocco
CME8082	Carcassa riduttore
CME8084	Coperchio riduttore LEPUS BOX 6000
CME8128	Biella di sblocco LEPUS BOX 6000
CME8130	Puleggia doppia
CME9008	Vite senza fine LEPUS BOX 6000
CMO1035	Motore LEPUS BOX 6000 400V/50Hz 3P
CTC1056	Molla preminnesto LEPUS BOX 6000
CTC1078	Molla
CTC1100	Paraolio 30x55x10
CTC1102	Paraolio 40x80x10
CTC1106	Paraolio 50x90x10
CTC1128	Seeger E50
CTC1137	Seeger I90
CVA1015	Frizione oleodinamica B20ZD28
CVA1017	Cinghiolo A-27
CVA1020	Boccola MB 35-35 DU
CVA1023	Tappo livello olio TLA4 20 0,5
CVA1025	Cilindretto serratura



TERMS OF SALES

EFFICACY OF THE FOLLOWING TERMS OF SALE: the following general terms of sale shall be applied to all orders sent to SEA srl. All sales made by SEA to all costumers are made under the prescription of this terms of sales which are integral part of sale contract and cancel and substitute all apposed clauses or specific negotiations present in order document received from the buyer.

GENERAL NOTICE The systems must be assembled exclusively with SEA components, unless specific agreements apply. Non-compliance with the applicable safety standards (European Standards EM12453 – EM 12445) and with good installation practice releases SEA from any responsibilities. SEA shall not be held responsible for any failure to execute a correct and safe installation under the above mentioned standards.

1) PROPOSED ORDER The proposed order shall be accepted only prior SEA approval of it. By signing the proposed order, the Buyer shall be bound to enter a purchase agreement, according to the specifications stated in the proposed order.

On the other hand, failure to notify the Buyer of said approval must not be construed as automatic acceptance on the part of SEA.

2) PERIOD OF THE OFFER The offer proposed by SEA or by its branch sales department shall be valid for 30 solar days, unless otherwise notified.

3) PRICING The prices in the proposed order are quoted from the Price List which is valid on the date the order was issued. The discounts granted by the branch sales department of SEA shall apply only prior to acceptance on the part of SEA. The prices are for merchandise delivered ex-works from the SEA establishment in Teramo, not including VAT and special packaging. SEA reserves the right to change at any time this price list, providing timely notice to the sales network. The special sales conditions with extra discount on quantity basis (Qx, Qx1, Qx2, Qx3 formula) is reserved to official distributors under SEA management written agreement.

4) PAYMENTS The accepted forms of payment are each time notified or approved by SEA. The interest rate on delay in payment shall be 1.5% every month but anyway shall not be higher than the max. interest rate legally permitted.

5) DELIVERY Delivery shall take place, approximately and not peremptorily, within 30 working days from the date of receipt of the order, unless otherwise notified. Transport of the goods sold shall be at Buyer's cost and risk. SEA shall not bear the costs of delivery giving the goods to the carrier, as chosen either by SEA or by the Buyer. Any loss and/or damage of the goods during transport, are at Buyer's cost.

6) COMPLAINTS Any complaints and/or claims shall be sent to SEA within 8 solar days from receipt of the goods, proved by adequate supporting documents as to their truthfulness.

7) SUPPLY The concerning order will be accepted by SEA without any engagement and subordinately to the possibility to get it's supplies of raw material which is necessary for the production; Eventual completely or partially unsuccessful executions cannot be reason for complains or reservations for damage. SEA supply is strictly limited to the goods of its manufacturing, not including assembly, installation and testing. SEA, therefore, disclaims any responsibility for damage deriving, also to third parties, from non-compliance of safety standards and good practice during installation and use of the purchased products.

8) WARRANTY The standard warranty period is 12 months. This warranty time can be extended by means of expedition of the warranty coupon as follows:

SILVER: The mechanical components of the operators belonging to this line are guaranteed for 24 months from the date of manufacturing written on the operator.

GOLD: The mechanical components of the operators belonging to this line are guaranteed for 36 months from the date of manufacturing written on the operator.

PLATINUM: The mechanical components of the operators belonging to this line are guaranteed for 36 months from the date of manufacturing written on the operator. The base warranty (36 months) will be extended for further 24 months (up to a total of 60 months) when it is acquired the certificate of warranty which will be filled in and sent to SEA s.r.l. The electronic devices and the systems of command are guaranteed for 24 months from the date of manufacturing. In case of defective product, SEA undertakes to replace free of charge or to repair the goods provided that they are returned to SEA repair centre. The definition of warranty status is by unquestionable assessment of SEA. The replaced parts shall remain propriety of SEA. Binding upon the parties, the material held in warranty by the Buyer, must be sent back to SEA repair centre with fees prepaid, and shall be dispatched by SEA with carriage forward. The warranty shall not cover any required labour activities.

The recognized defects, whatever their nature, shall not produce any responsibility and/or damage claim on the part of the Buyer against SEA. The guarantee is in no case recognized if changes are made to the goods, or in the case of improper use, or in the case of tampering or improper assembly. Furthermore, the warranty shall not apply if SEA products are partly or completely coupled with non-original mechanical and/or electronic components, and in particular, without a specific relevant authorization, and if the Buyer is not making regular payments. The warranty shall not cover damage caused by transport, expendable material, faults due to non-conformity with performance specifications of the products shown in the price list. No indemnification is granted during repairing and/or replacing of the goods in warranty. SEA disclaims any responsibility for damage to objects and persons deriving from non-compliance with safety standards, installation instructions or use of sold goods.

9) RESERVED DOMAIN A clause of reserved domain applies to the sold goods; SEA shall decide autonomously whether to make use of it or not, whereby the Buyer purchases propriety of the goods only after full payment of the latter.

10) COMPETENT COURT OF LAW In case of disputes arising from the application of the agreement, the competent court of law is the tribunal of Teramo. SEA reserves the faculty to make technical changes to improve its own products, which are not in this price list at any moment and without notice. SEA declines any responsibility due to possible mistakes contained inside the present price list caused by printing and/or copying. The present price list cancels and substitutes the previous ones. The Buyer, according to the law No. 196/2003 (privacy code) consents to put his personal data, deriving from the present contract, in SEA archives and electronic files, and he also gives his consent to their treatment for commercial and administrative purposes. Industrial ownership rights: once the Buyer has recognized that SEA has the exclusive legal ownership of the registered SEA brand, he will commit himself to use it in a way which does not reduce the value of these rights, he won't also remove, replace or modify brands or any other particularity from the products. Any kind of replication or use of SEA brand is forbidden as well as of any particularity on the products, unless preventive and expressed authorization by SEA.

In accomplishment with art. 1341 of the Italian Civil Law it will be approved expressly clauses under numbers:

4) PAYMENTS - 8) GUARANTEE - 10) COMPETENT COURT OF LOW



English GENERAL NOTICE FOR THE INSTALLER AND THE USER

1. Read carefully these Instructions before beginning to install the product. Store these instructions for future reference.
2. Don't waste product packaging materials and /or circuits.
3. This product was designed and built strictly for the use indicated in this documentation. Any other use, not expressly indicated here, could compromise the good condition/operation of the product and/or be a source of danger. SEA srl declines all liability caused by improper use or different use in respect to the intended one.
4. The mechanical parts must be comply with Directives: Machine Regulation 2006/42/CE and following adjustments), Low Tension (2006/95/CE), electromagnetic Consistency (2004/108/CE) Installation must be done respecting Directives: EN12453 and En12445.
5. Do not install the equipment in an explosive atmosphere.
6. SEA srl is not responsible for failure to observe Good Techniques in the construction of the locking elements to motorize, or for any deformation that may occur during use.
7. Before attempting any job on the system, cut out electrical power and disconnect the batteries. Be sure that the earthing system is perfectly constructed, and connect it metal parts of the lock.
8. Use of the indicator-light is recommended for every system, as well as a warning sign well-fixed to the frame structure.
9. SEA srl declines all liability as concerns the automated system's security and efficiency, if components used, are not produced by SEA srl.
10. For maintenance, strictly use original parts by SEA.
11. Do not modify in any way the components of the automated system.
12. The installer shall supply all information concerning system's manual functioning in case of emergency, and shall hand over to the user the warnings handbook supplied with the product.
13. Do not allow children or adults to stay near the product while it is operating. The application cannot be used by children, by people with reduced physical, mental or sensorial capacity, or by people without experience or necessary training. Keep remote controls or other pulse generators away from children, to prevent involuntary activation of the system.
14. Transit through the leaves is allowed only when the gate is fully open.
15. The User must not attempt to repair or to take direct action on the system and must solely contact qualified SEA personnel or SEA service centers. User can apply only the manual function of emergency.
16. The power cables maximum length between the central engine and motors should not be greater than 10 m. Use cables with 2,5 mm² section. Use double insulation cable (cable sheath) to the immediate vicinity of the terminals, in particular for the 230V cable. Keep an adequate distance (at least 2.5 mm in air), between the conductors in low voltage (230V) and the conductors in low voltage safety (SELV) or use an appropriate sheath that provides extra insulation having a thickness of 1 mm.

[illegible]



Questo articolo è stato prodotto seguendo rigide procedure di lavorazione ed è stato testato singolarmente al fine di garantire i più alti livelli qualitativi e la vostra soddisfazione. Vi ringraziamo per aver scelto SEA.

This item has been produced following strict production procedures and has been singularly tested for the highest quality levels and for your complete satisfaction. Thanks for choosing SEA.

Cet article a été produit suivant des procédures d'usinage strictes et il a singulièrement été testé afin de garantir les plus hauts niveaux de qualité pour votre satisfaction. Nous vous remercions d'avoir choisi SEA.

Este artículo ha sido producido siguiendo rigidos procedimientos de elaboracion y ha sido probando singolarmente a fin de garantizar los mas altos niveles de calidad y vuestra satisfaccion. Le agradecemos por haber escogito SEA.

CERTIFICATO DI ESTENSIONE GARANZIA

CERTIFICATE OF WARRANTY EXTENTION

n.

PRODOTTO/ PRODUCT

- Modello/Model _____
- Matricola n. /Serial Number _____
- Data di acquisto/Date of order _____
- Data di installazione/Date of installation _____

Centrale/Control unit

SEA ☐

Altri/Others ☐

Fotocellule/Photocells

SEA ☐

Altri/Others ☐

RX - TX

SEA ☐

Altri/Others ☐

Altri accessori /Other accessories

SEA ☐

Altri/Others ☐

UTENTE/Customer

Nome e Cognome _____

First Name and Family Name _____

Indirizzo/Address _____

INSTALLATORE/Installer

Ragione sociale/Company Name _____

Nome e Cognome/First and Family Name _____

Indirizzo/Address _____

INSTALLATORE/INSTALLER

Firma per il trattamento dei dati personali 196/2003

Agreement of law No. 196/2003 (Privacy Code)

Copia da restituire

Copy to be returned

Firma e Timbro

Sign and Stamp _____

N.B: L'estensione della garanzia legale di 12 mesi a 24 mesi e 36 mesi è valida solo se il presente modulo viene rispedito per posta o fax a SEA Srl entro 15gg dalla data di acquisto. Allegare relativa fattura d'acquisto.

Note: The extension of the legal standard warranty of 12 months to 24 months and to 36 months, is valid only if the present form is returned by mail or fax to SEA Srl within 15days from the date of purchase. Attach customer invoice.



SEA®
Sistemi Elettronici
di Apertura Porte e Cancelli
International registered trademark n. 804888

SEA srl - Zona Industriale San Atto- 64020 Teramo (Italy)

Phone +39 0861 588341- Fax +39 0861588344

www.seateam.com - info@seateam.com

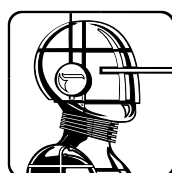

SEA[®]
Sistemi Elettronici
di Apertura Porte e Cancelli
International registered trademark n. 804888



SEA S.r.l.
Zona industriale 64020 S.ATTO Teramo - (ITALY)
Tel. 0861 588341 r.a. Fax 0861 588344

www.seateam.com

seacom@seateam.com